

## EN: STEAMAX – USER MANUAL

---

### FEATURES

Your STEAMAX Cleaner uses pressurized steam to remove tough grease, dirt, and grime. Steam is nature's purest and most powerful cleaning agent, safely cleaning all hard surfaces in your home without the use of harsh chemicals—making it an environmentally friendly solution.

The appliance includes several attachments that allow it to be used for a wide range of cleaning tasks, such as:

- Upholstery, grout, tiles, and stovetops
  - Reaching tight spaces with the extended sprayer rod
  - Refreshing fabrics, curtains, and bedding
  - Cleaning windows, mirrors, and glass doors
  - Removing buildup on countertops, sinks, and shower tracks
  - Cleaning kitchens, appliances, household surfaces, and vehicles
  - Providing effective degreasing, deep cleaning, sanitization, and disinfection
- 

### PRODUCT SPECIFICATIONS

**Rated voltage:** 100-240V

**Rated frequency:** 50/60Hz

**Max. Power rating:** 1600W

**IP rating:** IPX4

**Net. Package weight:** 1,54kg

---

### PRODUCT OVERVIEW

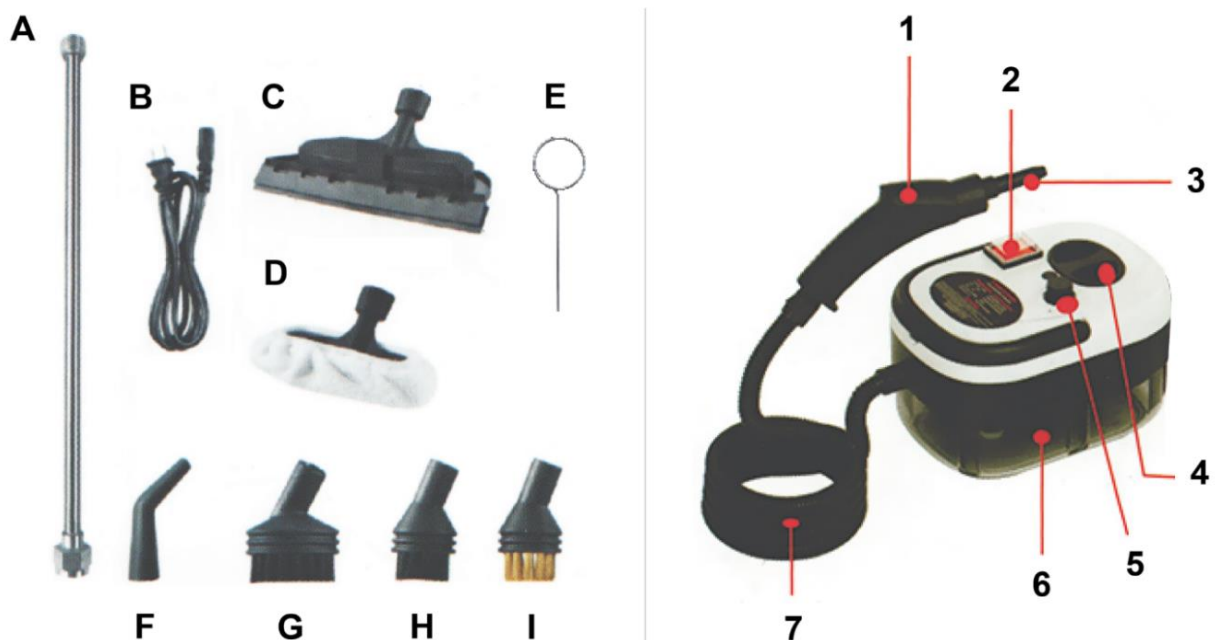

**Accessories:**

- A. Extended Sprayer Rod
- B. Power Cord
- C. Window Scraper
- D. Window Scraper with Towel Cover
- E. Safety Pin
- F. High-Pressure Nozzle
- G. Large Nylon Brush
- H. Nylon Brush
- I. Brass Brush

**Device Parts:**

- 1. Portable Handle
- 2. Power Button
- 3. Nylon Spray Nozzle
- 4. Safety Cap
- 5. Rotary Control Knob
- 6. Water Tank
- 7. 2 m Steam Outlet Hose

---

**IMPORTANT WARNINGS AND SAFETY INSTRUCTIONS**

To reduce the risk of fire, electric shock, or personal injury:

- This appliance is not a toy. Keep it out of reach of children.
  - Do not operate with a damaged cord or plug.
  - Do not use the steam cleaner if it has been dropped, damaged, left outdoors, or immersed in water.
  - Never service or clean the unit while it is plugged in.
  - Avoid contact with hot surfaces.
  - **WARNING:** Burns may occur from touching hot metal parts, hot water, or steam. Do not turn the unit upside down, as it may contain hot water. Never direct steam toward any person or animal—steam is extremely hot and can cause burns.
  - Do not expose the appliance to rain or moisture.
  - Store indoors in a dry location.
  - Do not place or store the unit where it may fall or be pulled into a sink or tub.
  - Unplug from the power outlet when not in use and before performing maintenance or troubleshooting.
  - Close supervision is required when the appliance is used by or near children. Never leave it unattended while connected to power.
  - Do not leave the steam cleaner plugged in when not in use.
  - Never operate the appliance without water in the tank.
  - **IMPORTANT:** Always ensure that the unit is **unplugged** from the wall socket before filling or refilling the water tank.
-

## USER INSTRUCTIONS

- **Step 1:** Before filling the steam cleaner, ensure that it is **unplugged**.
- **Step 2:** Remove the Safety Cap.
- **Step 3:** Add 40 fl. oz (1200 ml) of water using the provided filling flask. Do not overfill. Replace the Safety Cap securely.
- **Step 4:** Connect the Power Cord to your power outlet. The indicator light will turn on.
- **Step 5:** Select the appropriate steam nozzle or brush according to your cleaning needs, and hold the hand grip firmly.
- **Step 6:** Press the Power Button to turn on the appliance.
- **Step 7:** Allow the steam cleaner to preheat for about 15 seconds. It is normal if a small amount of water is expelled initially.
- **Step 8:** Adjust the steam output by turning the Rotary Control Knob.
- **Step 9:** After cleaning, press the Power Button to turn off the steam cleaner and unplug the Power Cord before refilling.
- **Step 10:** Remove the stopper and empty all remaining water from the tank after each use.
- **Step 11:** Allow the appliance to cool down completely before cleaning or storing. Store it in a cool, dry place.

---

## MAINTENANCE AND CARE

To maintain optimal performance and consistent high-temperature steam, it is important to prevent scale buildup inside the unit. If you notice reduced steam output or a blocked steam outlet, follow these steps to descale the appliance:

- **Step 1:** Mix citric acid with water in a 1:5 ratio.
- **Step 2:** Remove the nozzle and set the steam output to the maximum level by pressing the “Plus” button.
- **Step 3:** Run the machine normally for 5–10 minutes.
- **Step 4:** After descaling, refill the water tank with clean water and run the unit for another 5–10 minutes to rinse.
- **Step 5:** Turn off the machine and unplug it.

Regular descaling and maintenance will keep your STEAMAX cleaner operating efficiently and prolong its service life.

---

## INSTRUCTIONS FOR RECYCLING AND DISPOSAL:



This label means that the product cannot be disposed of as other household waste throughout the EU. To prevent potential damage to the environment or human health from uncontrolled waste disposal. Recycle responsibly to promote the sustainable use of material resources. If you want to return a used device, use the drop-off and collection system, or contact the retailer from whom you bought the product. The retailer can accept the product for environmentally safe recycling.



A declaration by the manufacturer that the product complies with the requirements of the applicable EU Directives.