

## EN: FUNLUNCHER – USER MANUAL

### Accessories List



1. Faucet adapter
2. Pedestal adapter
3. Pedestal
4. Water hose (5 m)
5. Toy rocket

---

### Installation Instructions

#### Connecting the pedestal and hose:

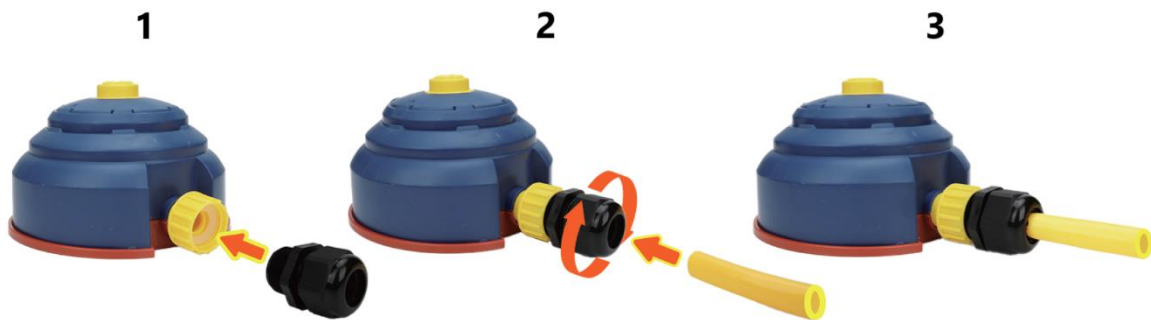

1. Firmly screw the pedestal adapter into the threaded opening of the pedestal.
2. Loosen the adapter by rotating the outer ring, then insert the water hose into the adapter opening.
3. Once the hose is inserted, rotate the adapter ring to tighten it and secure it in place.

Connecting the hose to the water pipe:



1. Loosen the faucet adapter.
2. Insert the hose into the adapter opening, ensuring the adapter ring is already placed over the hose.
3. Attach the adapter ring to the adapter base. Rotate the ring onto the threads and tighten it to secure the hose.
4. Connect the adapter to the water pipe. Once aligned with the pipe end, rotate the metal ring at the top to tighten the adapter securely. Ensure the connection is firm and leak-free.

---

**Product Use**

Place the toy rocket onto the pedestal and open the water flow gradually. Always begin by slowly turning on the faucet and gradually increasing the water pressure. The rocket will spin, rise, and fall in response to the water pressure, creating a fun and dynamic effect.

**⚠ Warning:**

Do **not** open the faucet abruptly or turn the water pressure to the maximum immediately. Doing so may damage the toy or cause it to fall unexpectedly.