

EN: DENTELA – USER MANUAL

GENERAL PRODUCT AND USER SAFETY

- The appliance must only be supplied with safety extra-low voltage corresponding to the markings on the device.
- This appliance can be used by children aged 8 years and above, and by persons with reduced physical, sensory, or mental capabilities, or lack of experience and knowledge, provided they are supervised or have been instructed on safe use of the appliance and understand the hazards involved. Children must not play with the appliance. Cleaning and user maintenance must not be performed by children without supervision.
- This device is contraindicated for persons with cardiac pacemakers.
- This is NOT a medical device.
- The tip must not come into contact with gingival (gum) soft tissues.
- **Performance characteristics:** This device is suitable for use only in indoor, dry environments. Continuous operating time must not exceed 6 minutes. Always switch off the device after each use.
- **Cleaning procedure:** Clean and dry the metal head after each use.
- **Intended use:** Basic tartar removal for personal oral care.

CHANGING THE METAL HEAD

The direction of the working tip may vary. As long as it is firmly installed, it can be used in any orientation.

Warning: If the connection is loose, the output will not be transmitted correctly. Ensure that the working tip is securely attached. Use the provided wrench kit to install the working tip. Do not use other tools to assemble or disassemble the device, as this may cause malfunction or damage.

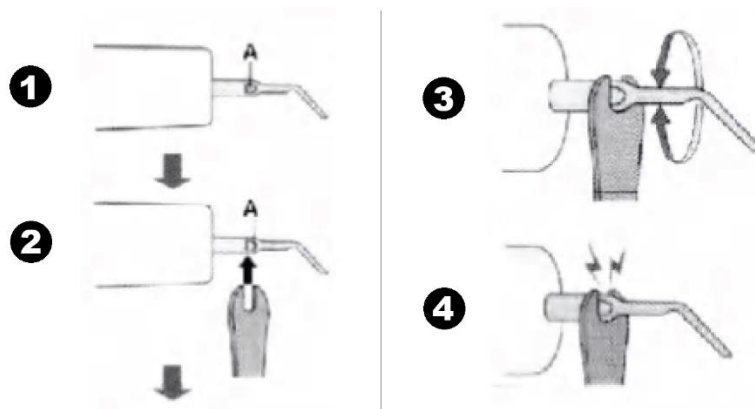

1. Confirm position A.
 2. Insert the spanner into position A.
 3. Rotate the head counterclockwise using the spanner to detach the working tip.
 4. **Precaution:** If the tip is excessively tight, improper disassembly may damage the interface.
-

PRODUCT OPERATION

For safety reasons, the device is supplied with a low battery level and is not fully charged. Please fully charge before first use.

- **Package contents:**

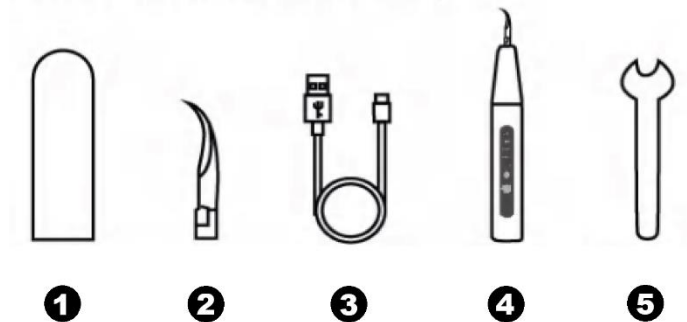

1. Protective cover
2. Dental tip
3. Charging cable
4. Main unit
5. Disassembly wrench

- Install the dental tip and tighten it using the disassembly wrench.
- Press and hold the power button for 1.5 seconds to turn on the device and enter mode selection. Press and hold again to turn off the device. Short press to switch between modes.
- Modes switch in the following sequence:
 1. **Soft:** Suitable for light tartar removal
 2. **Normal:** Suitable for daily cleaning
 3. **Middle:** Suitable for moderate stains (e.g., smoke or food stains)
 4. **Strong:** Recommended for heavy tartar buildup
 5. **Super:** Suitable for severe tartar buildup
- Press the LED light button above the power button to activate the auxiliary light.
- The device operates for up to 10 minutes and will automatically shut off.

Precautions for use: The cleaner is silent when powered on and is only effective when in contact with teeth.

FAQ

Why does the cleaner switch off during use?

If the battery indicator flashes during use, or the device turns off immediately after being switched on, the battery level is too low. Please recharge the device before use.

Is it normal for the dental tip and device to become slightly warm during use?

Yes, it is normal for the temperature to increase slightly due to internal components operating.

Is it normal for the cleaner to make noise during use?

Yes, some noise is normal. It may be caused by a loose dental tip or vibration (resonance). If the tip is loose, please tighten it securely.

INSTRUCTIONS FOR RECYCLING AND DISPOSAL:



This label means that the product cannot be disposed of as other household waste throughout the EU. To prevent potential damage to the environment or human health from uncontrolled waste disposal. Recycle responsibly to promote the sustainable use of material resources. If you want to return a used device, use the drop-off and collection system, or contact the retailer from whom you bought the product. The retailer can accept the product for environmentally safe recycling.



A declaration by the manufacturer that the product complies with the requirements of the applicable EU Directives.