

# EN: CUBELINK – USER MANUAL

## PRODUCT INTRODUCTION

This CUBELINK Intelligent Car Conversion Box is designed to enable **wireless connectivity between mobile phones and vehicle systems**. It integrates the functions of your smartphone with the car's display, converting traditional wired connections into a wireless experience. This device provides access to music and enhanced in-car entertainment while reducing the need to use your mobile phone during driving, helping to ensure a **safer and more enjoyable driving experience**.

---

## PRODUCT SPECIFICATIONS

**Product name:** CUBELINK

**Product model:** M4

**Input voltage:** 5V

**Operating temperature:** -20°C ~ +70°C

**Frequency spectrum:**

- **Bluetooth:** 2.402 – 2.480 GHz
- **Wi-Fi:** 2.412 – 2.472 GHz

**Max. Radio frequency power:**

- **Bluetooth:** 1.56 dBm
- **Wi-Fi:** 8.79 dBm

**Phone System Requirements:**

- **Wireless CarPlay:** iOS 12.1 or later
  - **Wireless Android Auto:** Android 10.0 or later
- 

## Compatibility Notes

If your vehicle is equipped with **wired CarPlay and/or wired Android Auto**, this device can convert the supported system to **wireless connectivity**.

You may need to enable the corresponding option in the vehicle's system settings (some vehicles do not require manual setup):

- iPhone users: Enable **CarPlay via Bluetooth**
- Android users: Enable **Android Auto via Bluetooth**

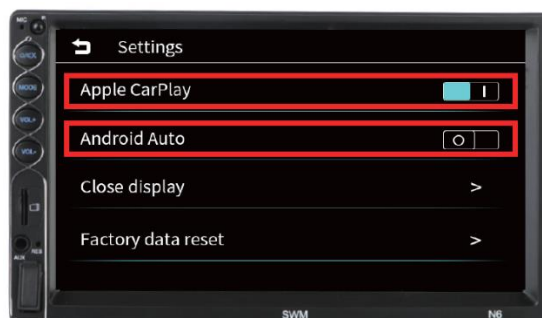

## Wireless CarPlay – iOS Phone Users

1. **Connect the device** to the original car USB or Type-C port.  
The system will read the device data and initiate the connection process.
2. **Turn on WLAN (Wi-Fi)** on your iPhone.

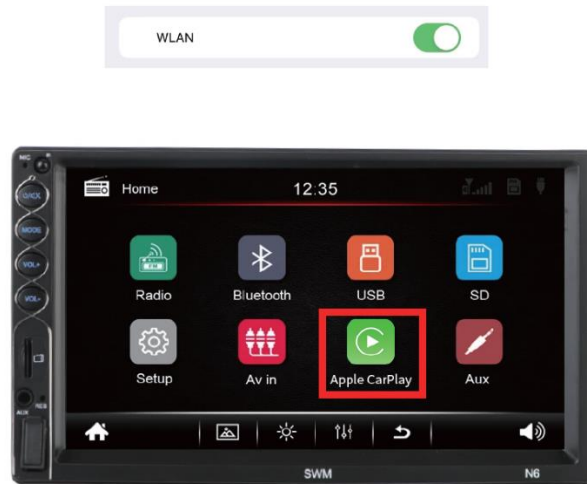

3. **Enable Bluetooth** on your iPhone and search for a Bluetooth device named: “WirelessDongle\_”, “smartBox-”, or “AIBox-BT\_\*\*\*\*”.  
Pair the device, allow synchronization, and select “Use CarPlay” when prompted.

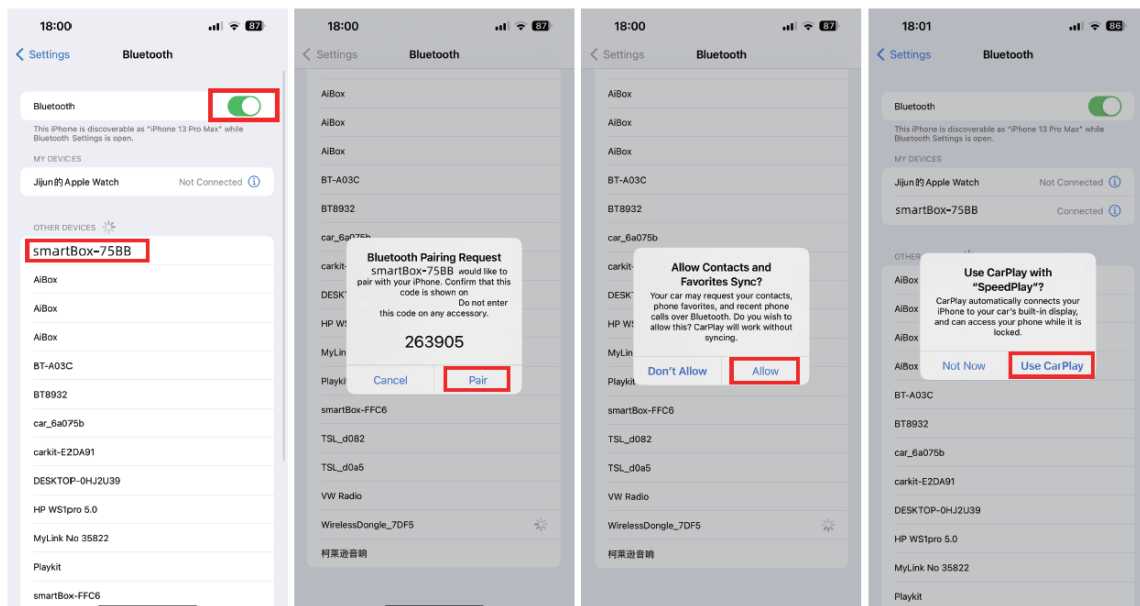

4. After the connection is established, please wait a few seconds.  
The **CarPlay interface** will appear on the vehicle display.



## Wireless Android Auto – Android Phone Users

1. **Connect the device** to the original car USB or Type-C port.  
The system will read the device data and wait for a connection.
2. **Turn on Wi-Fi** on your Android phone.



3. **Enable Bluetooth** on your phone and search for a Bluetooth device named:  
“WirelessDongle\_”, “smartBox-”, or “AiBox-BT\_\*\*\*\*”.  
Once the connection is successful, the device name will change to “**Your Car MyLink**”.

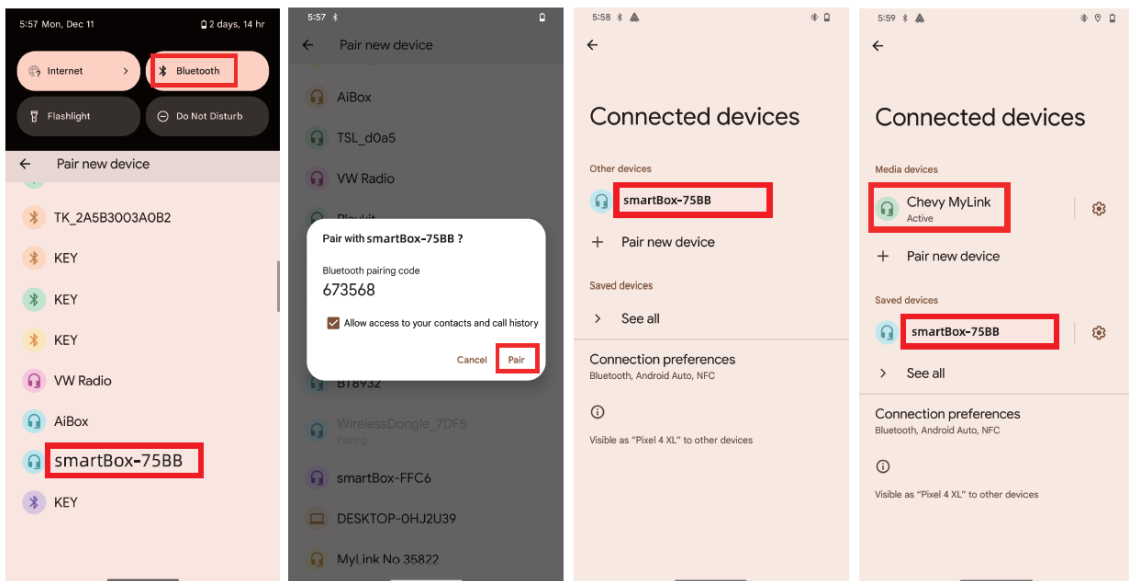

- After a short connection period, the **Android Auto interface** will be displayed.



---

## Q&A

### 1. How to Update the Product

- Connect the device to a **USB 5V power supply**, such as a phone charger or car charger USB port.  
*(Do not use the vehicle's original USB port for upgrading, as this may cause the update to fail.)*



- On your phone, connect to the Wi-Fi network named:  
"WirelessDongle\_", "smartBox-", or "AIBox-BT\_\*\*\*\*"  
**Password: 12345678**
- Open your web browser and enter the IP address:  
**192.168.1.101**
- Click **Upgrade** and wait a few minutes for the process to complete.

### Online updates

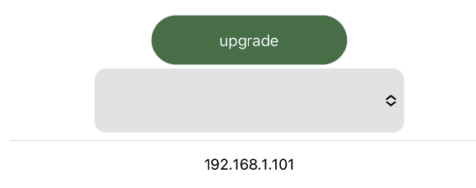

**Note:** After a successful upgrade, please forget/remove the Wi-Fi network from your phone.

---

## 2. How to Check if the AI Box Is Compatible with Your Car

- If your vehicle supports **only wired CarPlay**, the device can convert it to **wireless CarPlay only**.
- If your vehicle supports **only wired Android Auto**, the device can convert it to **wireless Android Auto only**.
- If your vehicle supports **both wired CarPlay and wired Android Auto**, the device can convert both to wireless versions.

*Note: The device only converts existing wired functionality to wireless; it does not add unsupported features.*

---

## 3. Do I Need to Reconnect the AI Box Every Time I Start the Car?

No. After the initial setup, the wireless CarPlay or Android Auto adapter will **automatically connect** to your phone via Bluetooth and Wi-Fi each time you start the vehicle.

---

## 4. How to Upload Log Data if the Device Does Not Work Properly

- Open the IP address page on your browser.
  - Fill in the vehicle information in the **problem description form**.
  - Click **Submit** to upload the log data for troubleshooting.
- 

## INSTRUCTIONS FOR RECYCLING AND DISPOSAL:



This label means that the product cannot be disposed of as other household waste throughout the EU. To prevent potential damage to the environment or human health from uncontrolled waste disposal. Recycle responsibly to promote the sustainable use of material resources. If you want to return a used device, use the drop-off and collection system, or contact the retailer from whom you bought the product. The retailer can accept the product for environmentally safe recycling.



A declaration by the manufacturer that the product complies with the requirements of the applicable EU Directives.

## EU DECLARATION OF CONFORMITY

Manufacturer: Dongguan KWD Technology Co., Ltd

Address: 9F, Building B, Caiqiao Industrial Park, Puxinhu, Tangxia Town, Dongguan City, Guangdong Province, P.R.C

Phone: 18505815587

Email: emmy@keepselected.cn

This declaration of conformity is issued under the sole responsibility of the manufacturer.

Product name: CUBELINK (Carplay)

Model no.: M4

The object of the declaration described above is in conformity with the relevant Union harmonization legislation:

**Directive 2014/53/EU on radio equipment and telecommunications equipment**

**RoHS Directive 2011/65/EU and amendment Commission Delegated Directive (EU) 2015/863**

References to the relevant harmonized standards used or references to the other technical specifications in relation to which conformity is declared:

**EN 62479:2010**

**EN IEC 62368-1:2020+A11:2020**

**EN 55032:2015 + A1:2020 + A11:2020**

**EN 55035:2017 + A11:2020**

**EN IEC 61000-3-2:2019+A1:2021**

**EN 61000-3-3:2013 + A2:2021**

**ETSI EN 301 489-1 V2.2.3(2019-11)**

**ETSI EN 301 489-17 V3.2.6(2023-01)**

**ETSI EN 300 328 V2.2.2 (2019-07)**

**ETSI EN 300 328 V2.2.2 (2019-07)**

**IEC62321-3-1:2013**

**IEC 62321-5:2013**

**IEC62321-4:2013+A1:2017**

**IEC62321-7-1:2015**

**IEC62321-7-2:2017**

**IEC62321-6:2015**

**IEC62321-8:2017**

Imported by: HS PLUS D.O.O., Gmajna 8, 1236 Trzin, Slovenia

Signed for and on behalf of (company name): Dongguan KWD Technology Co., Ltd

Place and date of issue: Dongguan, 2025.12.18

Name, function: Huizongli, General manager

Signature:

Stamp:

