

EN: BATTERYPOD – USER MANUAL

POWER DISPLAY OF THE POWER BANK

The battery level is displayed using four digits (25, 50, 75, 100), where each number represents 25% of the total charge. Refer to the highest displayed number to determine the remaining power level. For example:

- If only **25** and **50** are displayed, the battery level is between **25% and 50%**.
- If all numbers (**25, 50, 75, 100**) are displayed, the battery level is between **75% and 100%**.

The digital power display indicates the remaining charge, with **100** representing a fully charged state.

CHARGING METHODS

Method 1: Charging via Computer

1. Remove the charging cable from the package.
2. Connect the cable to the **DC-IN** port of the power bank and the USB port of your computer.
3. The charging indicator will flash while charging and will remain steady when fully charged.

Method 2: Charging via USB Adapter

1. Remove the charging cable from the package.
2. Connect the cable to the **DC-IN** port of the power bank and a **DC5V USB adapter**.
3. Plug the adapter into a power outlet.
4. The charging indicator will flash while charging and remain steady when fully charged.

How to Charge Other Devices

The power bank supports charging for mobile phones and digital devices that use a **DC-5V input**.

1. Use a compatible charging cable for the device.
2. If the power bank includes a **flashlight function**, double-click or press the button for **5 seconds** to turn the flashlight **on** or **off**.

MAINTENANCE

When you first receive the power bank, the power display may not be accurate. Follow these steps:

1. Fully discharge the power bank until the display shows **0%**.
2. Fully recharge it to **100%** without interrupting the charging process.
3. Repeat this cycle **three times** to improve the accuracy of the power display.

This power bank includes **four charging cables**, making it compatible with various mobile devices.

PRECAUTIONS

1. Before first use, fully charge the power bank. Even after the indicator lights up, continue charging for **an additional 20 minutes**.
2. Ensure the electronic device's screen is on while charging and that the connector is properly inserted.

3. If the blue power indicator turns off during charging, it indicates a **low battery**—recharge the power bank.
4. Once the electronic device is fully charged, unplug the cable to prevent unnecessary power loss.

SECURITY FEATURES

If the battery level suddenly drops from a relatively high percentage to **0%** during the first five uses (e.g., from **50% to 0%**), this is normal. It occurs because the power bank's **smart learning system** has not yet fully calibrated. Simply repeat the initial charging procedure outlined in this manual, and the battery will function properly in future uses.

It is normal for the power bank to generate **slight heat and noise** due to the **resistance and smart control chip** while charging.

Note: A thin **protective film** may be present on the display screen upon receipt. You can remove it if desired.

CHARGING OVERVIEW

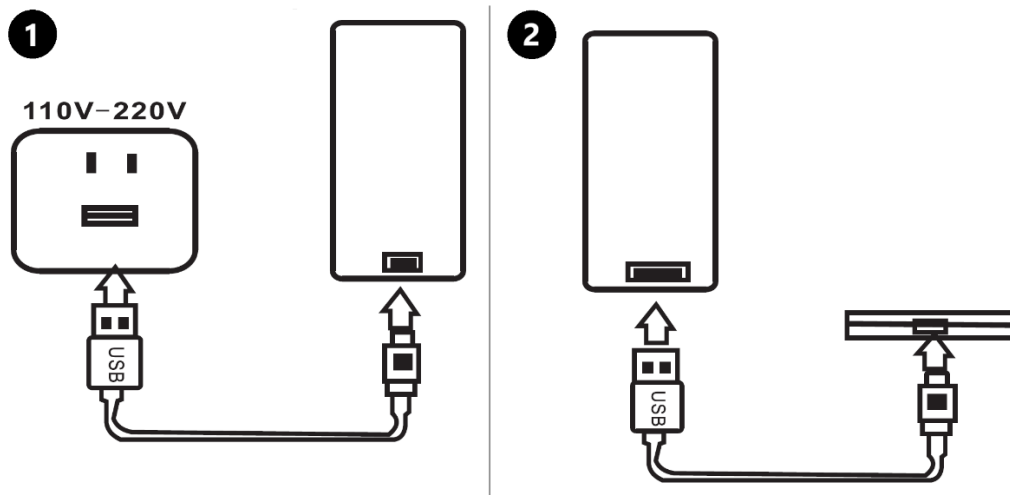

1. Charging the power bank
2. Using the power bank to charge other devices

Four-Wire Charger Includes:

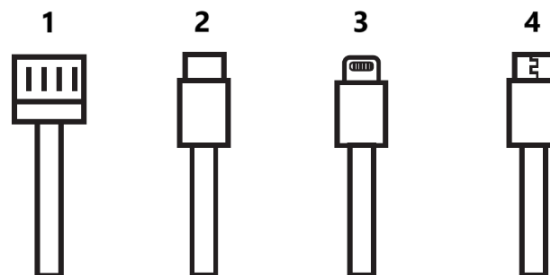

1. **USB**
2. **Type-C**
3. **Apple (Lightning)**
4. **Android (Micro-USB)**

Digital Product Charging Diagram

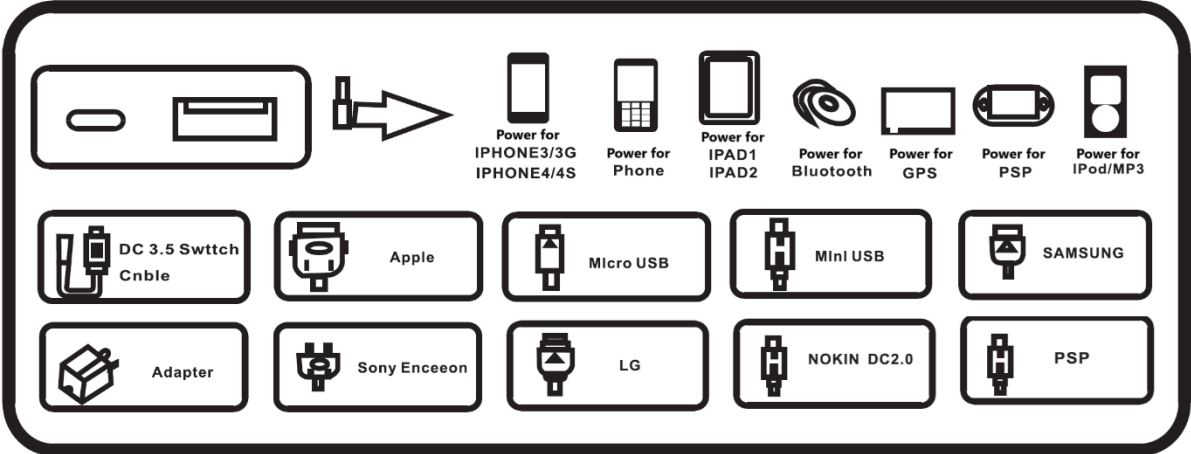

INSTRUCTIONS FOR RECYCLING AND DISPOSAL:



This label means that the product cannot be disposed of as other household waste throughout the EU. To prevent potential damage to the environment or human health from uncontrolled waste disposal. Recycle responsibly to promote the sustainable use of material resources. If you want to return a used device, use the drop-off and collection system, or contact the retailer from whom you bought the product. The retailer can accept the product for environmentally safe recycling.



A declaration by the manufacturer that the product complies with the requirements of the applicable EU Directives.