

EN: ACRSYNC – USER MANUAL

Compatibility Note

- Please ensure that your car supports wired CARPLAY or Android Auto functions.
 - Wireless CARPLAY requires an iPhone 6 or later with iOS 10 or higher.
 - Wireless Android Auto requires an Android smartphone running Android 11 or later and supporting the latest Android Auto functions.
-

Packing List

1 × USB-A data cable
1 × USB-C data cable
1 × User manual

Product Specifications

Model number: Y8
Frequency band(s): 2402MHz – 2480MHz
Maximum radio frequency power: 2,88dBm

How to Confirm if Your Car Has Wired Apple CARPLAY or Android Auto

Method 1: Connect your iPhone or Android smartphone to the car using a USB data cable. If your car display shows the CARPLAY or Android Auto logo, your vehicle supports it.

Method 2: Check the compatibility list on the official websites below, or confirm with your car manufacturer.

- Apple Carplay: <https://www.apple.com/ios/Carplay/available-models/>



- Android Auto: <https://www.android.com/auto/compatibility/>



How to Use

1. Start the car and wait for the infotainment system to fully load.
2. Connect the Wireless Carplay & Android Auto Adapter to the USB-A or USB-C port in your car. Be sure to use the port that supports wired Apple CARPLAY or Android Auto.
3. Once the device is linked to the vehicle, a Bluetooth prompt screen will appear. The adapter will be displayed as: "**smartBox-******".
4. Enable Bluetooth on your phone, search for "**smartBox-******", and pair with it. Confirm any prompts to continue. CARPLAY or Android Auto will now be available.
5. On some Android Auto-compatible cars, the Bluetooth prompt may not appear. In this case, search for "**smartBox-******" manually on your phone, pair it, and Android Auto will function normally.

You can now enjoy wireless CARPLAY or Android Auto.

Important: Keep your phone's Bluetooth enabled to allow automatic reconnection the next time you enter your car.

CARPLAY Connection

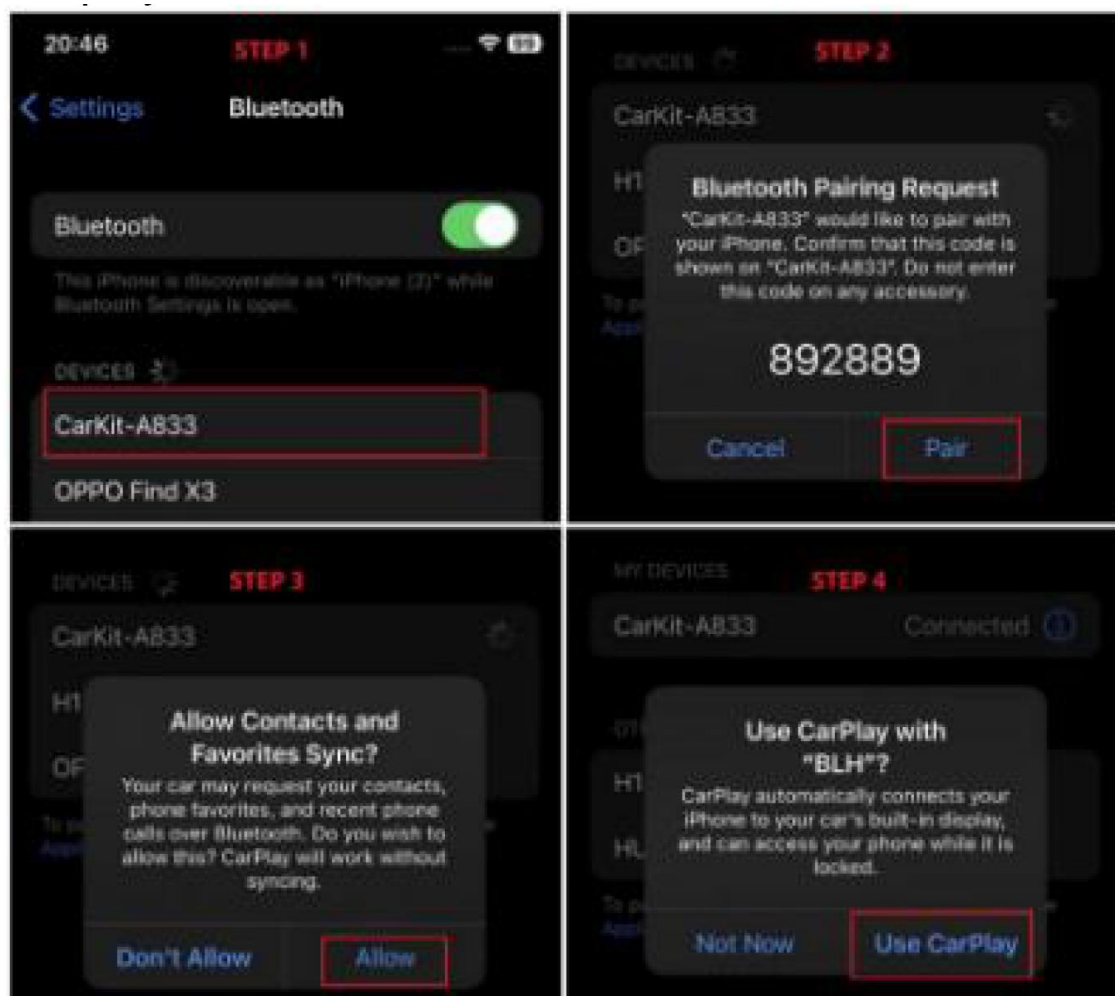

Android Auto Connection

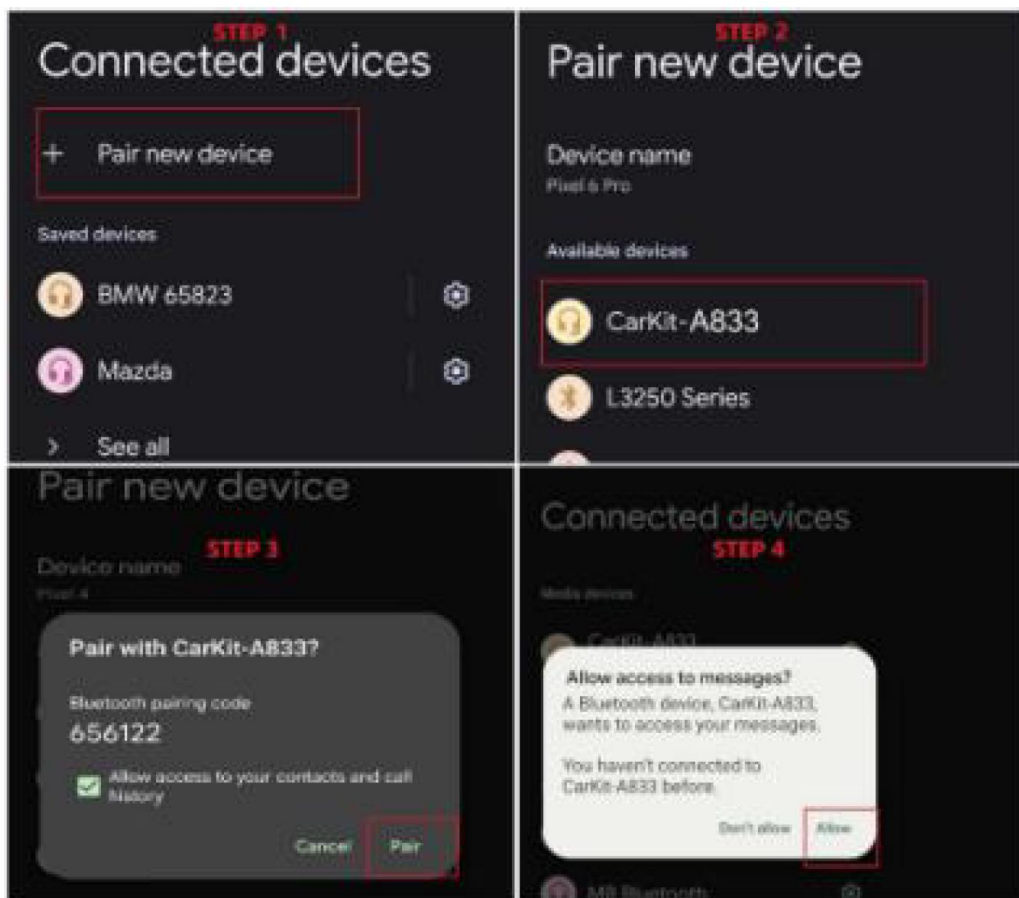

Please Note

1. The adapter first uses Bluetooth to establish pairing with your smartphone, then automatically switches to Wi-Fi to maintain the wireless connection.
2. Ensure that the adapter's indicator light is solid blue when in use.
3. The adapter only works with vehicles that support wired CARPLAY or Android Auto.

FAQ

What is the Wi-Fi password for the Wireless CARPLAY & Android Auto Adapter?

No Wi-Fi password is needed. The adapter connects via Bluetooth first, and Wi-Fi is established automatically afterward. Just make sure your phone's Wi-Fi is turned on and not connected to other networks.

After pairing, Android Auto does not start or the USB is not recognized.

1. If this is the first time using Android Auto in your car, connect your phone with a USB cable to activate Android Auto via the wired method.
2. Ensure your Android Auto app is updated to the latest version.

3. If issues persist, turn off your phone's Bluetooth, clear the Android Auto app cache, restart your phone, and then reconnect to the adapter.

Audio input/output issues (calls not working, no sound, interrupted playback, microphone issues, abnormal voice functions).

1. Ensure your phone is not connected to other Bluetooth devices such as headphones or smartwatches. Disconnect them before pairing with the adapter.
2. When making calls, confirm that your audio output is set to CARPLAY or Android Auto.

Can I use other Wi-Fi networks while connected to the adapter?

No. While connected, your phone's Wi-Fi is fully occupied by the adapter. Internet access will continue via your mobile data (SIM card).

The adapter does not reconnect automatically.

1. Make sure your phone's Bluetooth and Wi-Fi are turned on and not connected to other devices.
2. If reconnection still fails, delete the pairing record, restart your phone, and pair again.

Can the adapter be paired with multiple phones?

Yes. Up to five phones can be paired, but only one can connect at a time. If you want to connect a new phone, first disconnect the currently connected one.

Note: By default, the adapter automatically reconnects only to the last paired phone.

The adapter's Bluetooth/Wi-Fi does not appear.

1. Ensure the adapter's indicator light is solid blue and that it is plugged into the correct USB port that supports wired CARPLAY or Android Auto.
2. Test with another phone if possible.
 - If only one phone cannot find the adapter, reset that phone's network and Bluetooth settings, then restart it.
 - If the problem occurs with multiple phones, the adapter may be defective. Please contact customer support.

The indicator light stays on after turning off the car.

Some cars keep power to the USB ports for a short period after shutting off the engine. The adapter's light will turn off automatically after a few minutes. Its power consumption is minimal and will not drain your car battery.

Does the adapter support YouTube?

1. Wireless CARPLAY does not support YouTube playback.
2. Wireless Android Auto can support YouTube via third-party apps. To enable:
 - Open Google Chrome and search for "**AAAD APK**"
 - Download and install the APK
 - Open **AAAD** and download **CarStream**

- In CarStream, go to Settings and enable **Desktop Mode**
- You can now enjoy YouTube videos via wireless Android Auto.

INSTRUCTIONS FOR RECYCLING AND DISPOSAL:



This label means that the product cannot be disposed of as other household waste throughout the EU. To prevent potential damage to the environment or human health from uncontrolled waste disposal. Recycle responsibly to promote the sustainable use of material resources. If you want to return a used device, use the drop-off and collection system, or contact the retailer from whom you bought the product. The retailer can accept the product for environmentally safe recycling.



A declaration by the manufacturer that the product complies with the requirements of the applicable EU Directives.

EU DECLARATION OF CONFORMITY
According to EC Directive - CE

Manufacturer: Shenzhen Elebest Technology (HK) Co., LTD
Address: 3rd Floor, Building C, Century Technology Park, Shuo-tai Road, Komito Vellage, Guangming
New District, Shenzhen, China
Phone:
Email:Owen@elebest.com

This declaration of conformity is issued under the sole responsibility of the manufacturer.

Product name: ACRSYNC (Wireless carplay adapter)
Model no.: Y8

The object of the declaration described above is in conformity with the relevant Union harmonization legislation:

Radio Equipment Directive 2014/53/EU

EMC directive 2014/30/EU

RoHS directive 2011/65/EU and its amending Annex II (EU) 2015/863

References to the relevant harmonized standards used or references to the other technical specifications in relation to which conformity is declared:

ETSI EN 300 328 V2.2.2 (2019-07)

ETSI EN 301 489-1 V2.2.3 (2019-11)

ETSI EN 301 489-3 V2.3.2 (2023-01)

ETSI EN 301 489-17 V3.3.1 (2024-09)

EN 55032:2015+A11:2020

EN 55035:2017+A11:2020

IEC 62321-4:2013+AMD1:2017

IEC 62321-5: 2013

IEC 62321-6: 2015

IEC 62321-7-2: 2017

IEC 62321-8: 2017

EN IEC 62368-1:2020+A11:2020



Imported by: HS PLUS D.O.O., Gmajna 8, 1236 Trzin, Slovenia, EU

Signed for and on behalf of (company name): Shenzhen Elebest Technology (HK) Co., LTD

Place and date of issue: 2025/9/4

Name, function: Manager

Signature

Stamp



EU DECLARATION OF CONFORMITY
According to EC Directive - CE

Manufacturer: Shenzhen Elebest Technology (HK) Co., LTD
Address: 3rd Floor, Building C, Century Technology Park, Shuo-tai Road, Komito Vellage, Guangming
New District, Shenzhen, China
Phone:
Email:

This declaration of conformity is issued under the sole responsibility of the manufacturer.

Product name: ACRSYNC (Wireless carplay adapter)

Model no.: Y8

The object of the declaration described above is in conformity with the relevant Union harmonization legislation:

Radio Equipment Directive 2014/53/EU

EMC directive 2014/30/EU

RoHS directive 2011/65/EU and its amending Annex II (EU) 2015/863

References to the relevant harmonized standards used or references to the other technical specifications in relation to which conformity is declared:

ETSI EN 300 328 V2.2.2 (2019-07)

ETSI EN 301 489-1 V2.2.3 (2019-11)

ETSI EN 301 489-3 V2.3.2 (2023-01)

ETSI EN 301 489-17 V3.3.1 (2024-09)

EN 55032:2015+A11:2020

EN 55035:2017+A11:2020

IEC 62321-4:2013+AMD1:2017

IEC 62321-5: 2013

IEC 62321-6: 2015

IEC 62321-7-2: 2017

IEC 62321-8: 2017

EN IEC 62368-1:2020+A11:2020

Imported by: HS PLUS D.O.O., Gmajna 8, 1236 Trzin, Slovenia, EU

Signed for and on behalf of (company name): Shenzhen Elebest Technology (HK) Co., LTD

Place and date of issue:

Name, function:

Signature:

Stamp: